

## Elmfield Mansions, Elmfield Road, Balham SW17

Tenure: Leasehold Borough: Wandsworth

**£800,000**

- **Stunning three bedroom mansion apartment**
- **Excellent location moments from Balham station**



A stunning example of a period mansion apartment just off of Balham High Road. The property comprises three bedrooms, large reception room, modern kitchen-dining room, luxury bathroom, separate WC and utility room. Boasting high ceilings, bay window and period features throughout, the apartment is bright airy and beautifully finished. Elmsfield Mansions offers residents communal garden and sits in central Balham with its mainline and underground station a few moments away, cafes, shops, bars and restaurants all on your door step.

Tenure: Leasehold

# SW17 Elmfield Mansions, Elmfield Road, London

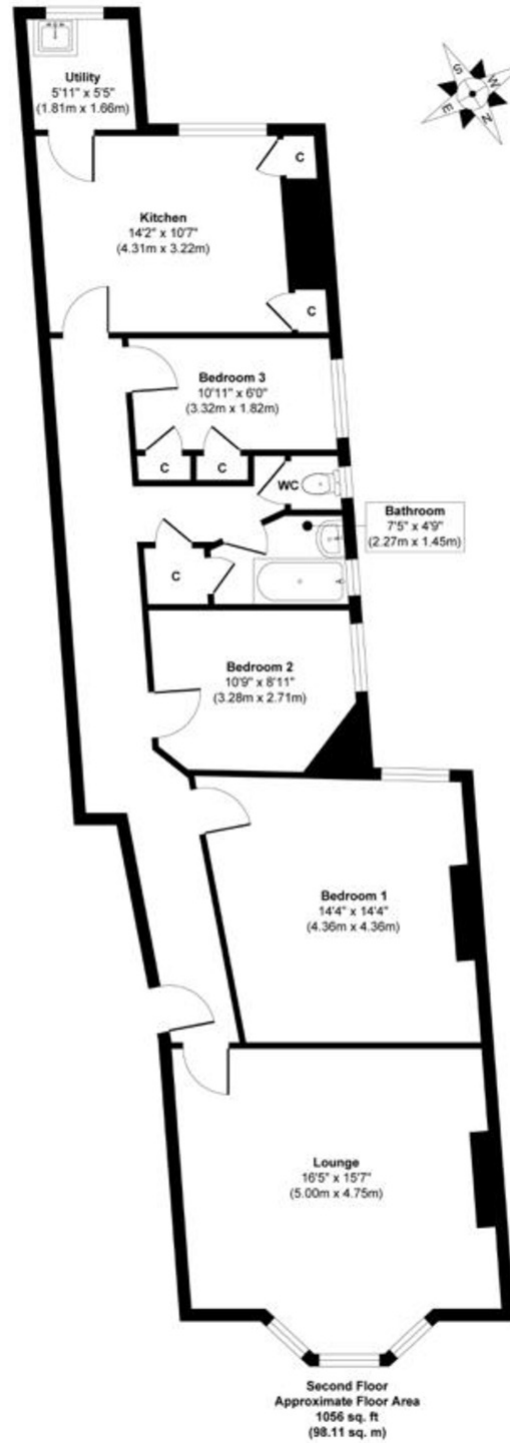

**Approx. Gross Internal Floor Area 1056 sq. ft / 98.11 sq. m**  
Illustration for identification purposes only, measurements are approximate, not to scale.

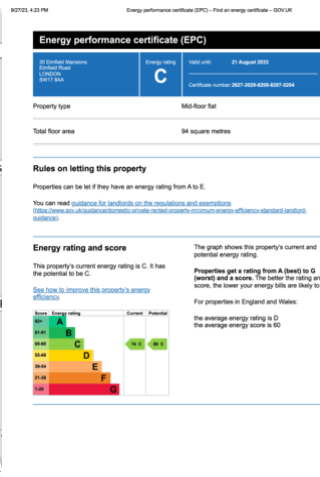

**Important Notice**

In accordance with the Property Misdescriptions Act (1991) we have prepared these sales particulars as a general guide to give a broad description of the property. They are not intended to constitute part of an offer or contract. We have not carried out a structural survey and the services, appliances and specific fittings have not been tested. All photographs, measurements, floor plans and distances referred to are given as a guide only and should not be relied upon for the purchase of carpets or any other fixtures or fittings. Lease details, service charges and ground rent (where applicable) are given as a guide only and should be checked and confirmed by your solicitor prior to exchange of contracts.