

The High, Streatham Hill SW16

Tenure: Leasehold Borough: Lambeth

£300,000

- Moments from Streatham Hill station
- Bright accommodation

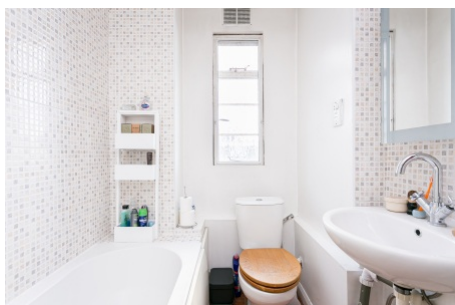

A bright and spacious one bedroom flat in a well regarded purpose built mansion block on the High Road. The flat is in good decorative order and benefits from a lift and telephone entry system. There are shops, bars and restaurants on the doorstep with Streatham Hill stations within a short walking distance.

The High

Approximate Gross Internal Area
53 sq m / 570 sq ft

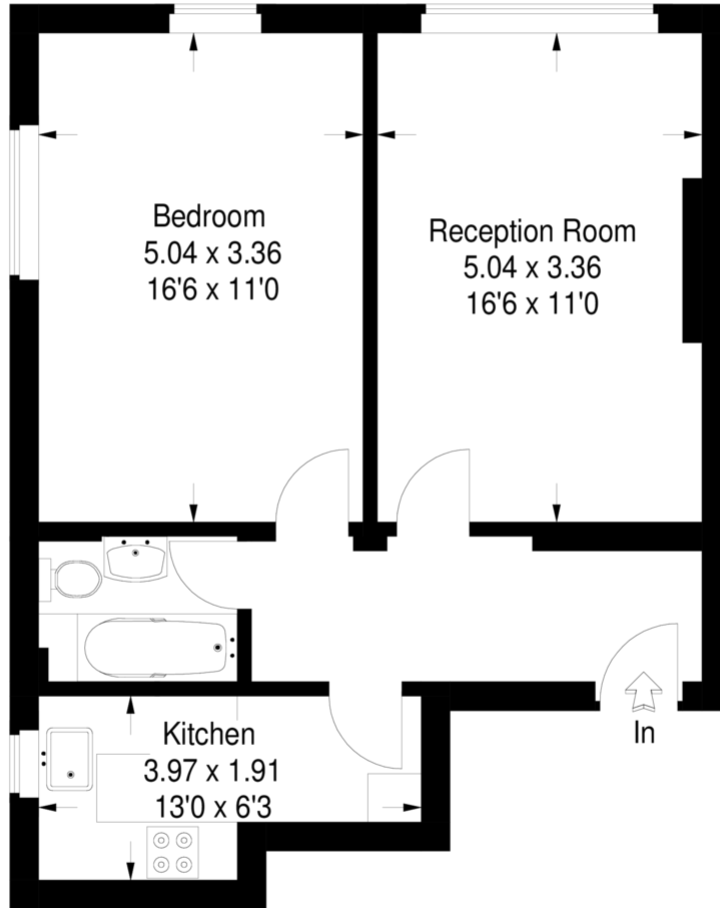

Fifth Floor

This plan is for layout guidance only. Not drawn to scale unless stated. Windows & door openings are approximate. Whilst every care is taken in the preparation of this plan, please check all dimensions, shapes & compass bearings before making any decisions reliant upon them. (ID50045)

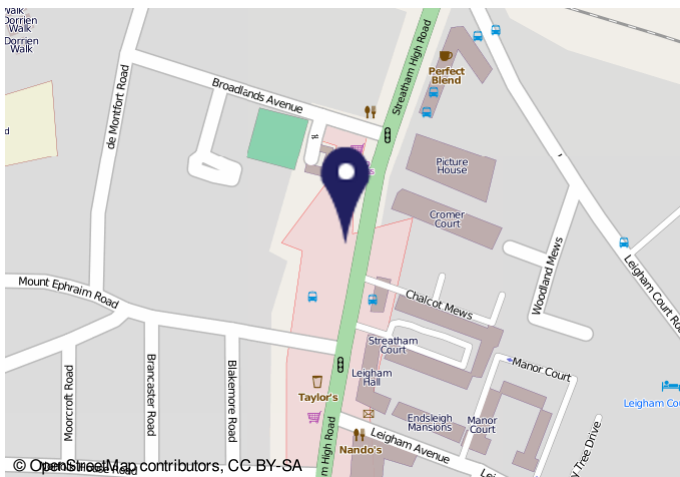

Energy performance certificate (EPC)	
Full title: The High, Broadlands High Road, LONDON, SW19 1JY	Valid until: 19 June 2030
Energy rating: D	Certificate number: 9860-6536-9866-1071-2292
Property type: Top-floor flat	Total floor area: 48 square metres

Rules on letting this property

Properties can be rented if they have an energy rating from A to E.

If the property is rated F or G, it cannot be let, unless an exemption has been registered. You can read guidance for landlords on the regulations and exemptions [here](https://www.gov.uk/guidance/landlords-owners-and-tenants).

Energy efficiency rating for this property

The property's current energy rating is D. It has the potential to be D.

[See how to improve this property's energy performance.](#)

The graph shows this property's current and potential energy efficiency.

Current	Potential
45-55	45-55

Properties are given a rating from A (most efficient) to G (least efficient).

Properties are also given a score. The higher the number the lower your fuel bills are likely to be.

For properties in England and Wales:
the average energy rating is D
the average energy score is 60

Important Notice

In accordance with the Property Misdescriptions Act (1991) we have prepared these sales particulars as a general guide to give a broad description of the property. They are not intended to constitute part of an offer or contract. We have not carried out a structural survey and the services, appliances and specific fittings have not been tested. All photographs, measurements, floor plans and distances referred to are given as a guide only and should not be relied upon for the purchase of carpets or any other fixtures or fittings. Lease details, service charges and ground rent (where applicable) are given as a guide only and should be checked and confirmed by your solicitor prior to exchange of contracts.