

The High, Streatham Hill SW16

Borough: Lambeth

£1,100 pcm

- Moments from Streatham Hill station
- Bright accommodation

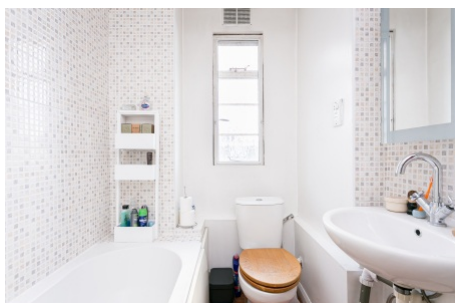

A bright and spacious one bedroom flat in a well regarded purpose built mansion block on the High Road. The flat is in good decorative order and benefits from a lift and telephone entry system. There are shops, bars and restaurants on the doorstep with Streatham Hill stations within a short walking distance.

The High

Approximate Gross Internal Area
53 sq m / 570 sq ft

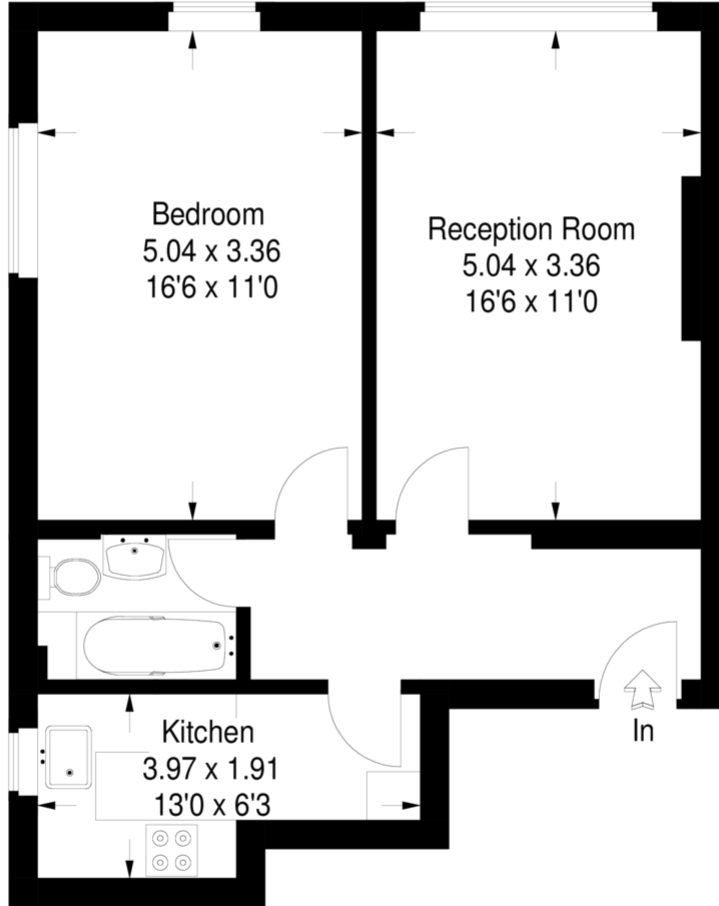

Fifth Floor

This plan is for layout guidance only. Not drawn to scale unless stated.
Windows & door openings are approximate. Whilst every care is taken in the preparation of this plan, please check all dimensions, shapes & compass bearings before making any decisions reliant upon them. (ID50045)

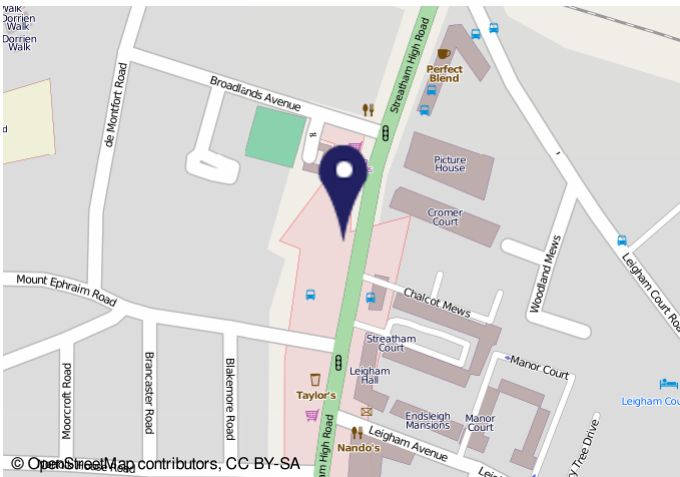

Energy Efficiency Rating		Environmental Impact (CO ₂) Rating	
Current	Potential	Current	Potential
A	B	D	C
B	C	C	B
C	D	B	A
D	E	A	A
E	F	A	A
F	G	A	A
G	G	A	A

Estimated energy use, carbon dioxide (CO ₂) emissions and fuel costs of this home		
Current	Potential	
Energy Use	595 kWh/m ² per year	448 kWh/m ² per year
Carbon dioxide emissions	4.8 tonnes per year	3.4 tonnes per year
Lighting	£39 per year	£24 per year
Heating	£989 per year	£561 per year
Hot water	£52 per year	£32 per year

Important Notice
In accordance with the Property Misdescriptions Act (1991) we have prepared these sales particulars as a general guide to give a broad description of the property. They are not intended to constitute part of an offer or contract. We have not carried out a structural survey and the services, appliances and specific fittings have not been tested. All photographs, measurements, floor plans and distances referred to are given as a guide only and should not be relied upon for the purchase of carpets or any other fixtures or fittings. Lease details, service charges and ground rent (where applicable) are given as a guide only and should be checked and confirmed by your solicitor prior to exchange of contracts.