

Kingswood Road , Brixton Hill SW2

Tenure: Leasehold Borough: Lambeth

£550,000

- Stunning period conversion with two double bedrooms
- Lovely private garden



This beautiful two bedroom, garden flat is arranged over the whole ground floor of this attractive Victorian building. The property also comprises a huge, open kitchen/dining/reception space that leads to the pretty private garden via large French doors. In the garden is a wonderful garden studio that could be a great workspace or additional summer living room. The bathroom is beautifully appointed and encompasses a very large shower area. The flat is stunningly presented throughout and is close to the shops, bars and restaurants of Brixton Hill, Abbeville Village and Northern Line/Tube access at Clapham South.

Kingswood Road

Approximate Gross Internal Area = 60.8 sq m / 654 sq ft
Garden Room = 9.7 sq m / 104 sq ft
Total = 70.5 sq m / 758 sq ft

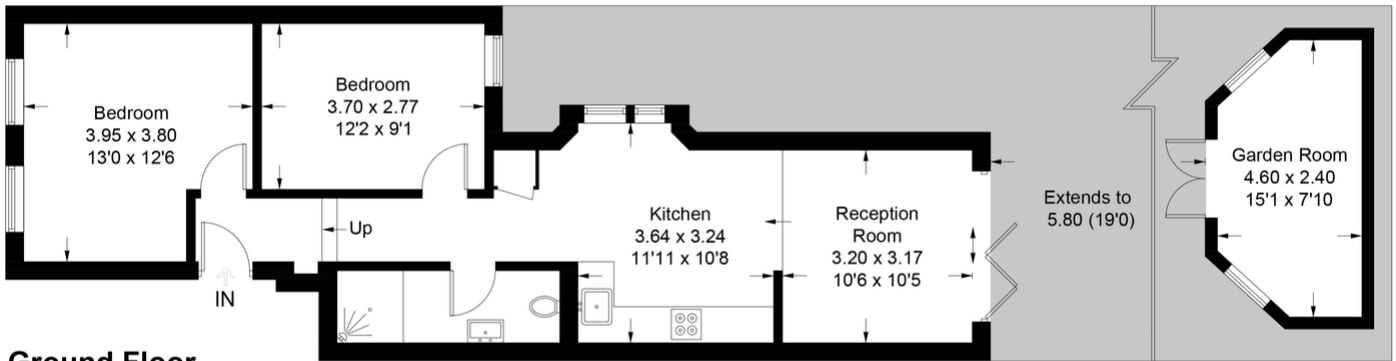

Ground Floor

This plan is for layout guidance only. Not drawn to scale unless stated. Windows and door openings are approximate. Whilst every care is taken in the preparation of this plan, please check all dimensions, shapes and compass bearings before making any decisions reliant upon them. (ID627497)

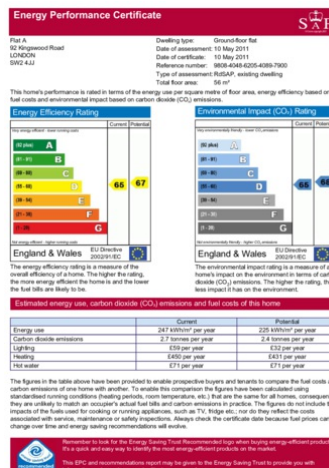
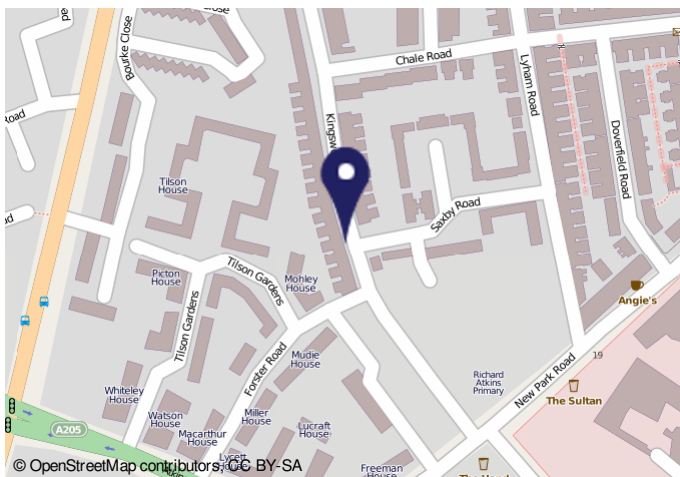

Important Notice
In accordance with the Property Misdescriptions Act (1991) we have prepared these sales particulars as a general guide to give a broad description of the property. They are not intended to constitute part of an offer or contract. We have not carried out a structural survey and the services, appliances and specific fittings have not been tested. All photographs, measurements, floor plans and distances referred to are given as a guide only and should not be relied upon for the purchase of carpets or any other fixtures or fittings. Lease details, service charges and ground rent (where applicable) are given as a guide only and should be checked and confirmed by your solicitor prior to exchange of contracts.