

Hopton Road, Streatham SW16

Borough: Lambeth

£1,600 pcm

- One bedroom flat
- Seperate kitchen



A smart one bedroom flat located on Hopton Road. This flat comprises spacious living room, double bedroom, tiled bathroom and kitchen fitted with appliances. The property is located within close proximity of Streatham High Road, the amenities and Streatham Station. This flat is available now.

Hopton Road

Approximate Gross Internal Area
46.2 sq m / 497 sq ft

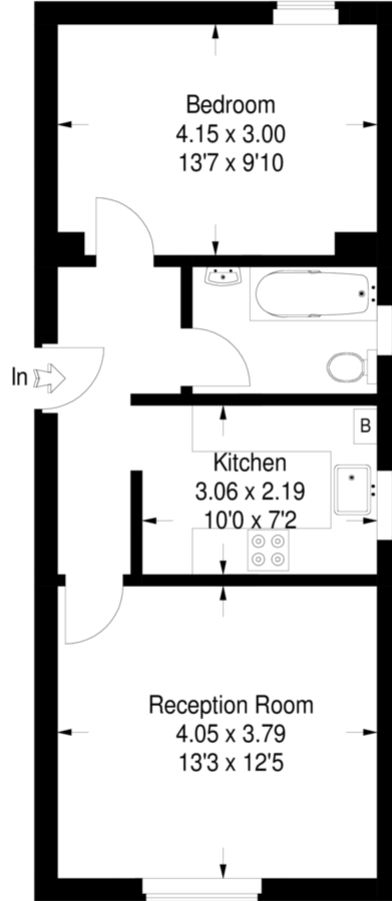

Ground Floor

This plan is for layout guidance only. Not drawn to scale unless stated. Windows & door openings are approximate. Whilst every care is taken in the preparation of this plan, please check all dimensions, shapes & compass bearings before making any decisions reliant upon them. (ID189664)

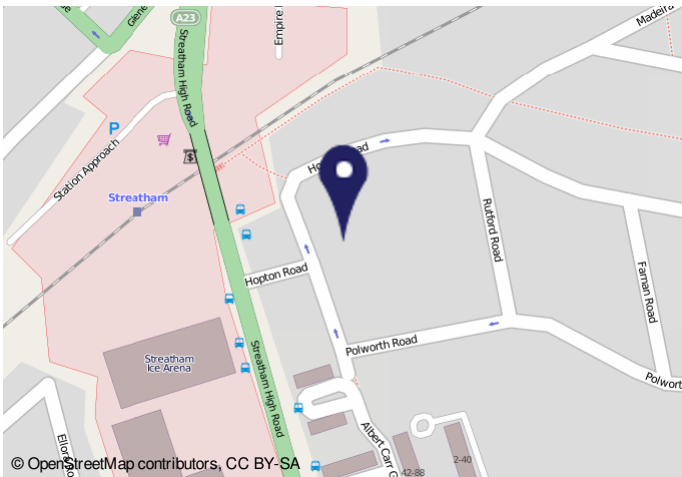

Energy Performance Certificate			
<p>Plot 2, 10 Hopton Road LONDON SW16 6SD</p>		<p>Dwelling type: Ground-floor flat Date of assessment: 21 February 2012 Date of certificate: 21 February 2012 Reference number: EPC-022-0200-0008-7008 Type of assessment: RPSAP, existing dwelling Total floor area: 46 m²</p>	
<p>This home's performance is rated in terms of energy use per square metre of floor area, energy efficiency based on fuel costs and environmental impact based on carbon dioxide (CO₂) emissions.</p>		<p>The energy efficiency rating is a measure of the overall efficiency of a home. The higher the rating, the more energy efficient the home is and the lower the fuel bills are likely to be.</p>	
<p>England & Wales 30/03/2018-01/10/2020 0-100</p>		<p>England & Wales 30/03/2018-01/10/2020 0-100</p>	
<p>Estimated energy use, carbon dioxide (CO₂) emissions and fuel costs of this home</p>			
	Current	Potential	
Energy use	365 kWh/year per year	341 kWh/year per year	
Carbon dioxide emissions	3.1 tonnes per year	2.8 tonnes per year	
Lighting	£28 per year	£27 per year	
Heating	£582 per year	£558 per year	
Hot water	£82 per year	£82 per year	

Important Notice
In accordance with the Property Misdescriptions Act (1991) we have prepared these sales particulars as a general guide to give a broad description of the property. They are not intended to constitute part of an offer or contract. We have not carried out a structural survey and the services, appliances and specific fittings have not been tested. All photographs, measurements, floor plans and distances referred to are given as a guide only and should not be relied upon for the purchase of carpets or any other fixtures or fittings. Lease details, service charges and ground rent (where applicable) are given as a guide only and should be checked and confirmed by your solicitor prior to exchange of contracts.