

Wellfield Road, Streatham SW16

Borough: Lambeth

£1,400 pcm

- One bedroom flat
- Spacious and light



A bright and spacious one bedroom flat on the ground floor of this converted Victorian building. This property comprises; living room with bay window, separate fitted kitchen, double bedroom with fitted wardrobes and bathroom. Neutral décor throughout, having been recently redecorated and new carpets laid. Wellfield Road is located within close proximity to Streatham High Road and its excellent array of shops, bars and restaurants as well as many bus routes and three train stations. Available now, unfurnished.

Rent (£1,400pcm), 5 week security Deposit (£1,615.00). 12 month tenancy. Council tax band C, Lambeth.

Wellfield Road

Approximate Gross Internal Area = 41.4 sq m / 446 sq ft

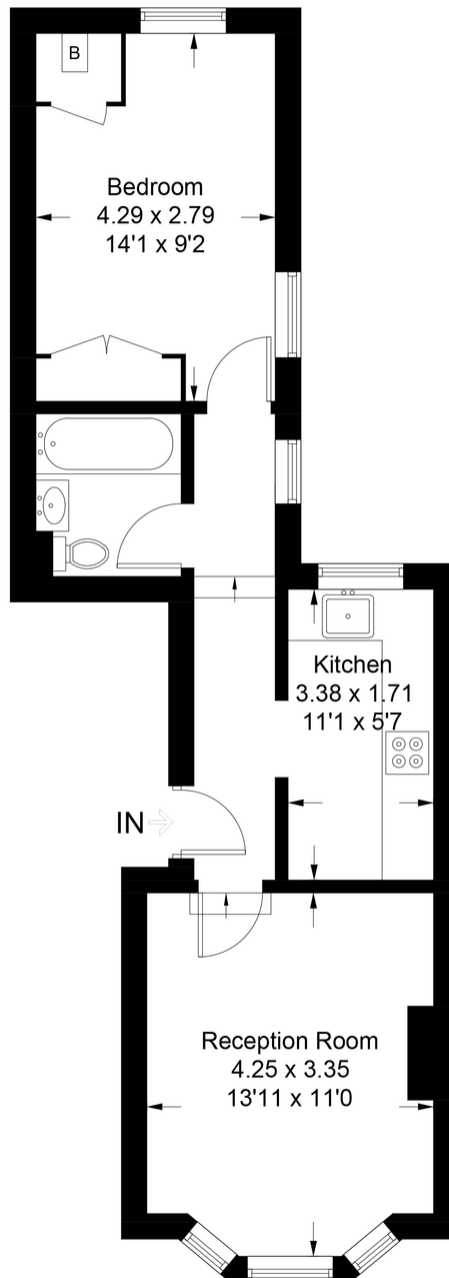

Ground Floor

This plan is for layout guidance only. Not drawn to scale unless stated. Windows and door openings are approximate. Whilst every care is taken in the preparation of this plan, please check all dimensions, shapes and compass bearings before making any decisions reliant upon them. (ID998816)

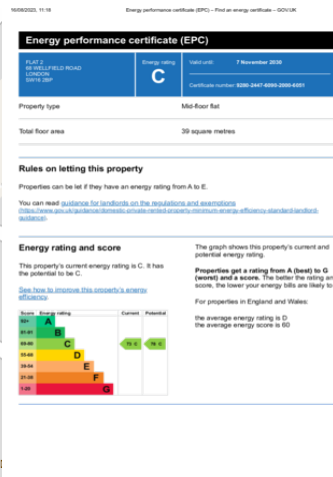
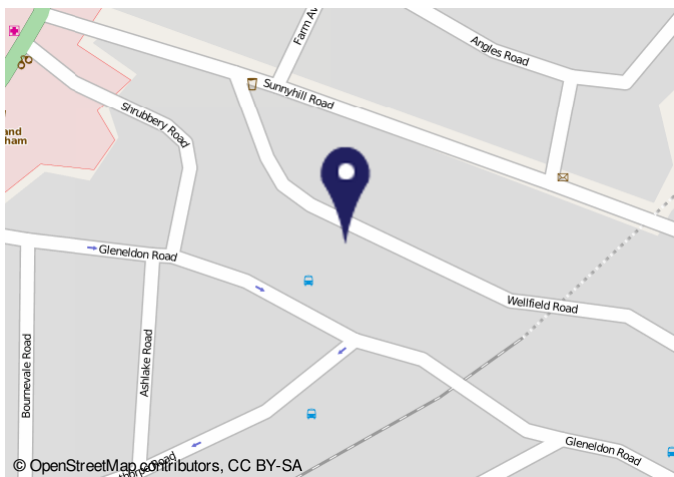

Important Notice
In accordance with the Property Misdescriptions Act (1991) we have prepared these sales particulars as a general guide to give a broad description of the property. They are not intended to constitute part of an offer or contract. We have not carried out a structural survey and the services, appliances and specific fittings have not been tested. All photographs, measurements, floor plans and distances referred to are given as a guide only and should not be relied upon for the purchase of carpets or any other fixtures or fittings. Lease details, service charges and ground rent (where applicable) are given as a guide only and should be checked and confirmed by your solicitor prior to exchange of contracts.